



SEAT S.A.



SEAT & CUPRA

Fleet Interface Activation

Adjustment of Privacy Settings for all SEAT & CUPRA vehicles

Thank you for using our service „Fleet Interface“. In order to activate data transmission into your company internal fleet management systems, privacy settings need to be adjusted manually in your vehicles` HMI to complete the fleet-in process. This document provides a step-by-step guide for the service setup to initiate the data flow.

Please make sure to follow the steps as described:

- 1 Confirm vehicle delivery in FleetCom.
- 2 Register vehicle for the service “Fleet Interface” via the system API (please find more information in our development guide chapter 4 “Use Cases”, sub chapter 4.2 “Vehicle Registration”) in our customer portal.
- 3 Check vehicle registration within Fleet Interface via the end point “Vehicle Registration” (please find more information in our development guide chapter 4 “Use Cases”, sub chapter 4.2 “Vehicle Registration”) in our customer portal.
- 4 After completed registration: manual selection of privacy settings “Share vehicle Location” in vehicle HMI as described on the following pages.



Important Notice:

Please register your vehicles first via the Fleet Interface and check the actual registration status before selecting the Privacy Settings in the respective vehicle HMI manually.



Contents

1	Adjustment of Privacy Settings for all SEAT/CUPRA vehicles with MIB3 architecture.	4
	Leon	
	CUPRA Leon	
	CUPRA Formentor	
2	Adjustment of Privacy Settings for all SEAT/CUPRA vehicles with MIB3 architecture.	6
	Ibiza	
	Arona	
	Ateca	
	CUPRA Ateca	
	Tarraco	

1. Adjustment of Privacy Settings for all SEAT & CUPRA vehicles with MIB3 architecture.

Leon, Formentor y Terramar

Step 1



In the main menu of your vehicle, swipe through the menu until you find the Users tile. Select the Users icon.

Step 2



The Users submenu will open. Select the icon for the privacy settings located on the left.

Step 3

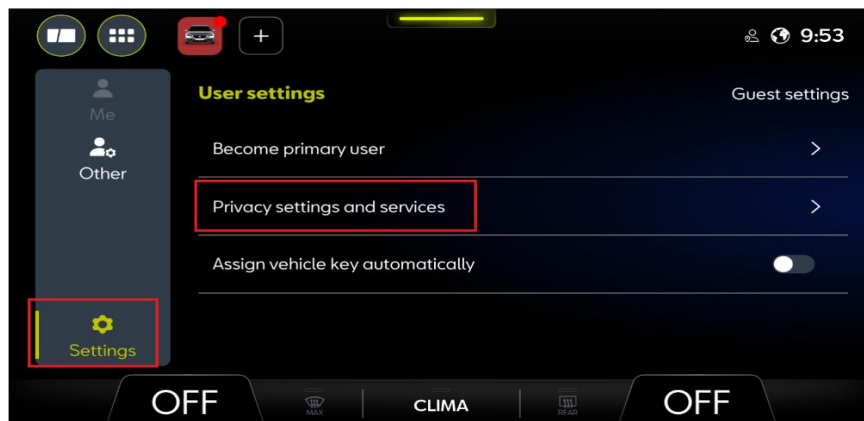

The user profile settings of your vehicle will open. Click on Privacy Settings and Services.

Step 4

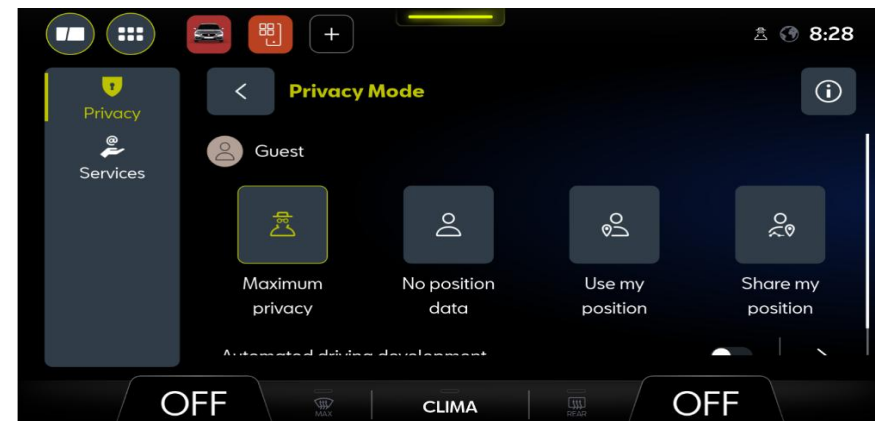

Once the Privacy Mode menu is open, the option Maximum Privacy is selected by default.

1. Adjustment of Privacy Settings for all SEAT & CUPRA vehicles with MIB3 architecture.

Continuation of page 4

Step 4 (cont.)



Change from Maximum Privacy to Share my position.

Step 5

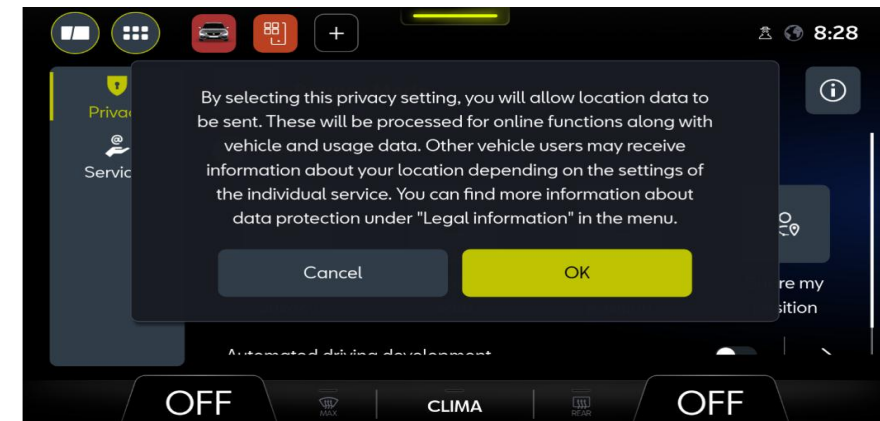

A pop-up will appear informing about the terms and conditions of sharing your position. Click OK to start sharing.

2. Adjustment of Privacy Settings for all SEAT & CUPRA vehicles with MIB3 architecture.

e.g. Ibiza, Arona, Ateca, Tarraco

Step 1

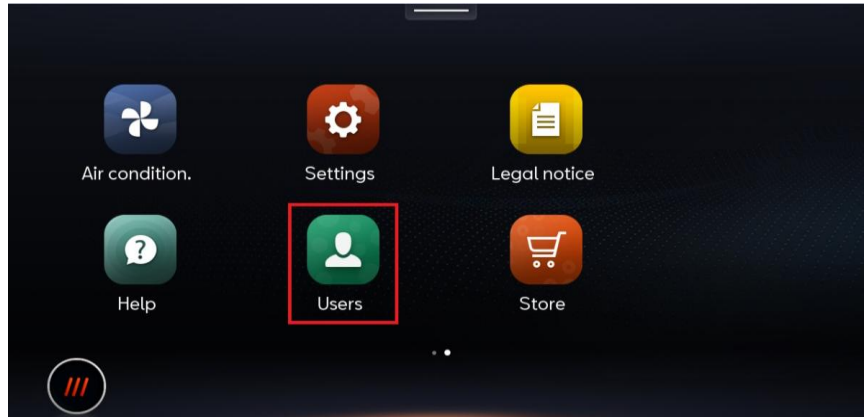

In the main menu of your vehicle, swipe through the menu until you find the Users tile. Select the Users icon.

Step 3

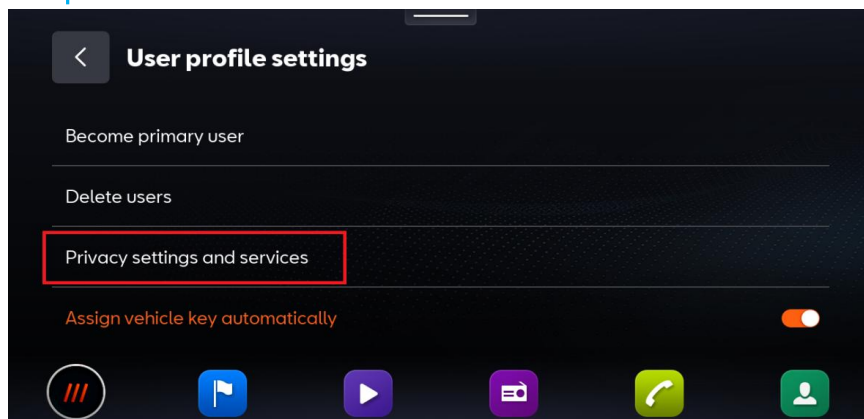

The user profile settings of your vehicle will open. Click on Privacy Settings and Services.

Step 2

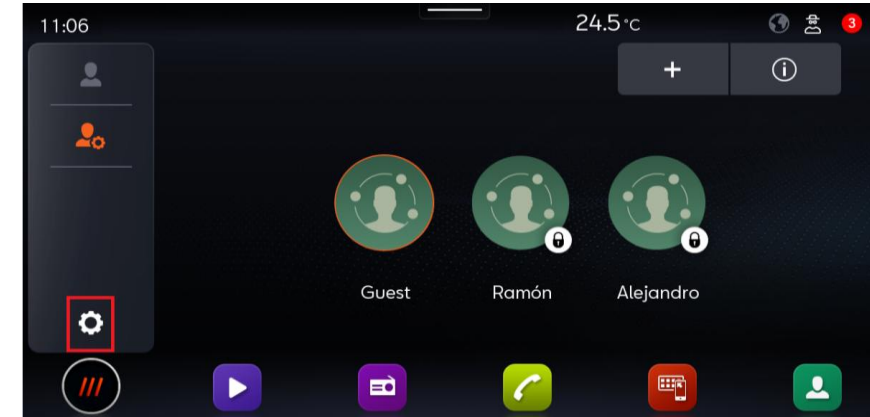

The Users submenu will open. Select the icon for the privacy settings located on the left.

Step 4

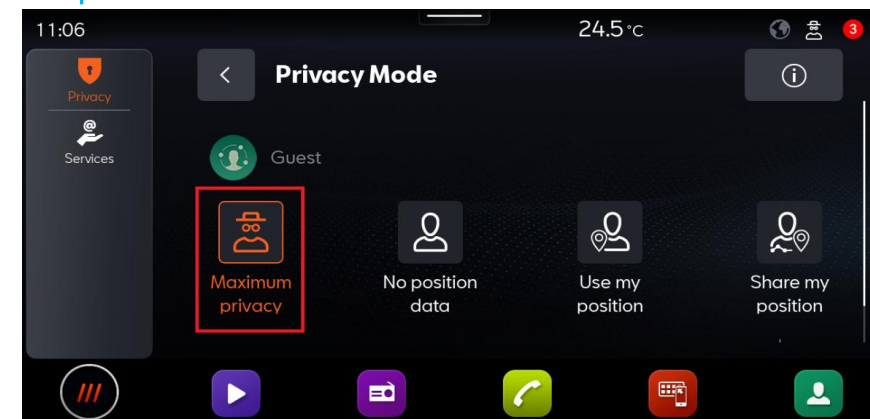

Once the Privacy Mode menu is open, the option Maximum Privacy is selected by default.

2. Adjustment of Privacy Settings for all SEAT & CUPRA vehicles with MIB3 architecture.

Continuation of page 6

Step 4 (cont.)

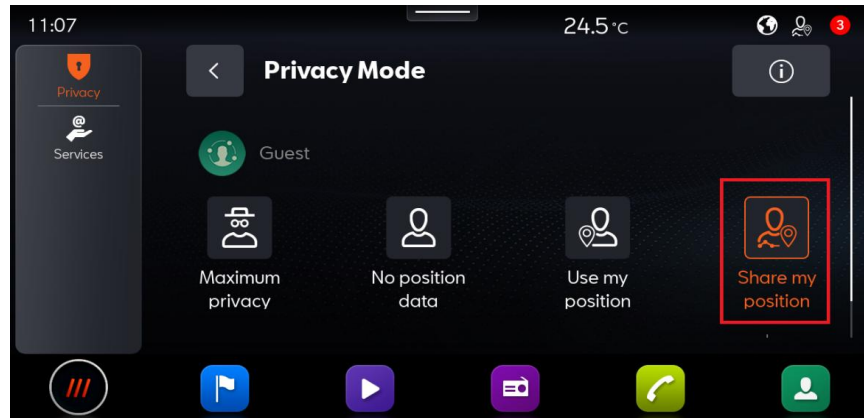

Change from Maximum Privacy to Share my position.

Step 5

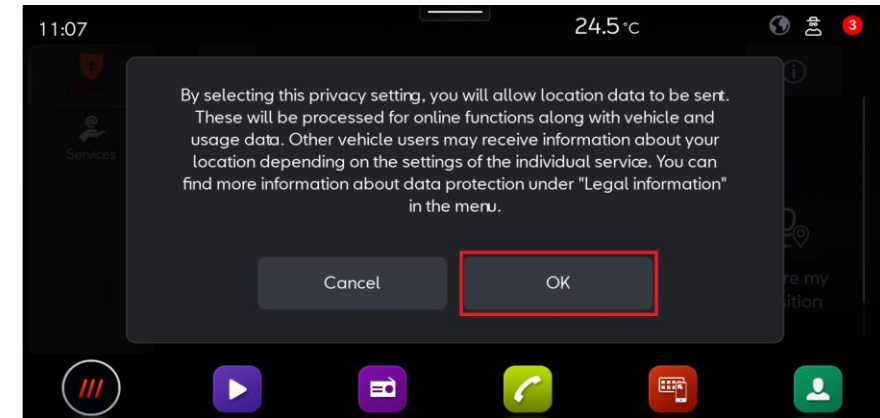

A pop-up will appear informing about the terms and conditions of sharing your position. Click OK to start sharing.



SEAT S.A.